



Размеры и  
технические  
характеристики

Dimensions and technical data

Abmessungen und Auswahltabelle

Dimensions et caractéristiques techniques

Dimensiones y datos técnicos

B5

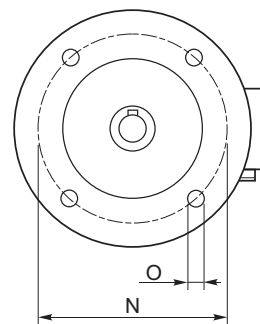
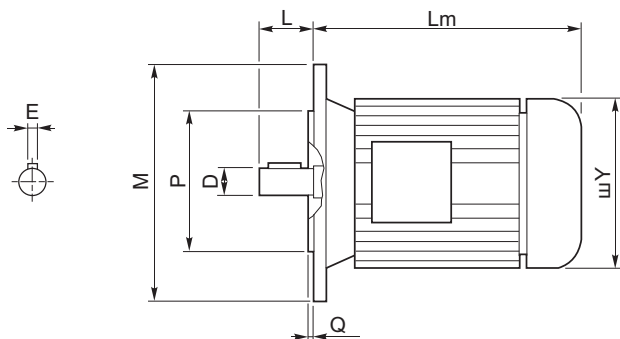

B14

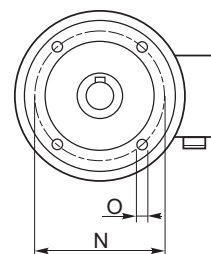
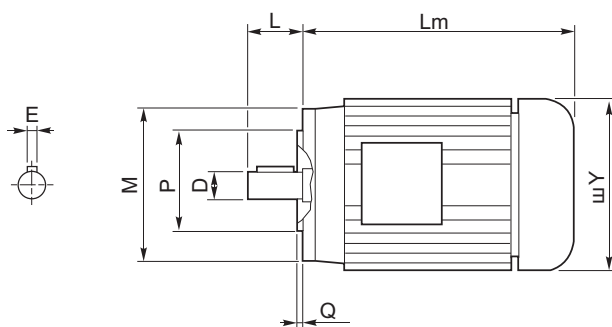

Наружные размеры определяются производителем.

Outside dimensions may be different according to manufacturers.

Den jeweiligen Herstellern gemäß können die Außenmaße unterschiedlich ausfallen.

Les dimensions extérieures peuvent changer en fonction des différents fabricants.

|        | 2 полюса / poles |      |                     | 4 полюса / poles |      |                     | 6 полюсов / poles |      |                     | B5-B14 |    |    |                |     |     | B5  |     |     |      |     | B14 |     |     |     |     | K <sub>g</sub> |
|--------|------------------|------|---------------------|------------------|------|---------------------|-------------------|------|---------------------|--------|----|----|----------------|-----|-----|-----|-----|-----|------|-----|-----|-----|-----|-----|-----|----------------|
|        | kW               | Nm   | A <sub>(400V)</sub> | kW               | Nm   | A <sub>(400V)</sub> | kW                | Nm   | A <sub>(400V)</sub> | D      | E  | L  | L <sub>m</sub> | Y   | AD  | P   | N   | M   | O    | Q   | P   | N   | M   | O   | Q   |                |
| 56 A   | 0.09             | 0.32 | 0.38                | 0.06             | 0.44 | 0.27                | —                 | —    | —                   | 9      | 3  | 20 | 179            | 108 | 96  | 80  | 100 | 120 | 9    | 2.5 | 50  | 65  | 80  | M5  | 2.5 | 2.7            |
| 56 B   | 0.12             | 0.42 | 0.46                | 0.09             | 0.67 | 0.37                | —                 | —    | —                   |        |    |    |                |     |     |     |     |     |      |     |     |     |     |     |     | 2.9            |
| 63 A   | 0.18             | 0.63 | 0.60                | 0.12             | 0.84 | 0.50                | 0.09              | 0.99 | 0.57                | 11     | 4  | 23 | 185            | 120 | 99  | 95  | 115 | 140 | 9.5  | 3   | 60  | 75  | 90  | M5  | 2.5 | 3.8            |
| 63 B   | 0.25             | 0.87 | 0.76                | 0.18             | 1.30 | 0.69                | 0.12              | 1.32 | 0.74                |        |    |    |                |     |     |     |     |     |      |     |     |     |     |     |     | 4.2            |
| 71 A   | 0.37             | 1.30 | 1.00                | 0.25             | 1.70 | 0.91                | 0.18              | 1.90 | 0.80                | 14     | 5  | 30 | -              | 130 | 104 | 110 | 130 | 160 | 9.5  | 3.5 | 70  | 85  | 105 | M6  | 2.5 | 5.9            |
| 71 B   | 0.55             | 1.90 | 1.54                | 0.37             | 2.52 | 1.14                | 0.25              | 2.72 | 1.10                |        |    |    | 225            | 141 | 107 |     |     |     |      |     |     |     |     |     |     | 6.5            |
| 80 A   | 0.75             | 2.60 | 1.85                | 0.55             | 3.77 | 1.51                | 0.37              | 3.84 | 1.18                | 19     | 6  | 40 | 256            | 159 | 127 | 130 | 165 | 200 | 11.5 | 3.5 | 80  | 100 | 120 | M6  | 3   | 8.5            |
| 80 B   | 1.1              | 3.90 | 2.64                | 0.75             | 5.11 | 2.57                | 0.55              | 5.84 | 1.80                |        |    |    |                |     |     |     |     |     |      |     |     |     |     |     |     | 10             |
| 90 S   | 1.5              | 5.00 | 3.31                | 1.1              | 7.45 | 2.78                | 0.75              | 7.92 | 2.32                | 24     | 8  | 50 | -              | 170 | 135 | 130 | 165 | 200 | 11.5 | 3.5 | 95  | 115 | 140 | M8  | 3   | 12.5           |
| 90 L   | 2.2              | 7.50 | 4.46                | 1.5              | 10.2 | 3.61                | 1.1               | 11.6 | 3.45                |        |    |    | 280            | 15  |     |     |     |     |      |     |     |     |     |     |     |                |
| 100 LA | 3.0              | 10.0 | 6.28                | 2.2              | 14.8 | 5.07                | 1.5               | 15.4 | 3.88                | 28     | 8  | 60 | -              | 190 | 148 | 180 | 215 | 250 | 13   | 4   | 110 | 130 | 160 | M8  | 3.5 | 20             |
| 100 LB | —                | —    | —                   | 3.0              | 20.1 | 6.66                | —                 | —    | —                   |        |    |    | 22             |     |     |     |     |     |      |     |     |     |     |     |     |                |
| 112 M  | 4.0              | 13.4 | 8.10                | 4.0              | 26.7 | 8.55                | 2.2               | 22.6 | 5.30                |        |    |    | 321            | 210 | 164 |     |     |     |      |     |     |     |     |     |     | 35             |
| 132 S  | 5.5              | 18.3 | 11.2                | 5.5              | 36.5 | 11.4                | 3.0               | 30.2 | 7.20                | 38     | 10 | 80 | 375            | 244 | 180 | 230 | 265 | 300 | 14   | 4   | 130 | 165 | 200 | M10 | 4   | 41             |
|        | 7.5              | 24.9 | 15.3                |                  |      |                     |                   |      |                     |        |    |    |                |     |     |     |     |     |      |     |     |     |     |     |     | 51             |
| 132 M  | —                | —    | —                   | 7.5              | 49.4 | 15.0                | 4.0               | 40.0 | 9.13                |        |    |    |                |     |     |     |     |     |      |     |     |     |     |     |     | 420            |



**Защита**  
Стандарт IP44  
Необходимо указать в заказе, если требуется соответствие стандарту IP55 или выше.

**Protection**  
Standard IP44  
To be specified upon placing the order if IP55 or higher protection is required

**Schutzart**  
IP44 Standard.  
IP55 oder höher im Auftrag angeben.

**Degré de protection**  
IP44 standard.  
Au moment de la commande, spécifiez si vous souhaitez l'IP55 ou supérieur.

**Grado de protecciyon**  
IP44 standard.  
Especificar al efectuar el pedido el IP55 y superior.

**Изоляция**  
Стандарт CI. F  
Необходимо указать в заказе, если требуется другой тип изоляции.

**Insulation**  
Standard CI.F  
To be specified upon placing the order if different insulation is required.

**Isolierung**  
CI.F Standard.  
Davon abweichende Isolierungsklasse im Auftrag angeben

**Isolement**  
CI.F standard.  
Au moment de la commande, spécifiez si vous souhaitez une classe d'isolement différente.

**Aislamiento**  
CI.F standard.  
Especificar al efectuar el pedido la clase diferente de aislamiento.

| Макс. темп. | Изоляция / Insulation<br>Isolierung / Isolement / Aislamiento |      |      |      |      |
|-------------|---|------|------|------|------|
|             | C°  | 120° | 130° | 155° | 175° |
|             | F*  | 248° | 266° | 311° | 347° |

**Соединения**

**Connections**

**Verbindungselemente**

**Branchements**

**Conexiones**

Трёхфазный асинхронный односкоростной  
Threephase asynchronous single polarity  
Asynchronmotor 3-ph eine Drehzahl  
Moteur triphasé a une vitesse  
Asincrono trifasico de una velocidad

Трёхфазный асинхронный двухскоростной  
Asynchronmotor 3-ph doppelte Drehzahl  
Moteur triphasé a deux vitesses  
Asincrono trifasico de dos velocidades

Однофазный асинхронный  
Single phase asynchronous  
Einphasen-Asynchronmotor  
Moteur monophasé  
Asincrono monofasico

